



Air conditioner

Quick Guide

AR**BVHC****

- Thank you for purchasing this Samsung air conditioner.
- Before operating this unit, please read this manual carefully and retain it for future reference.

SAMSUNG

Preparation

Registering the product / Reading the manual / Connecting to Services

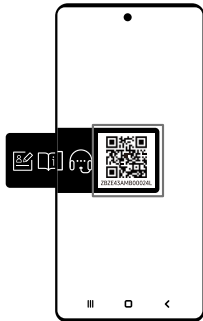

- 1 Launch a QR code reader app and scan the QR code image on the product.
- 2 Choose the desired menu from the Product Registration, Manual, Customer Support. If you choose 'Manual' you can read the manual of the product you purchased.

NOTE

- We provide online manuals that can be accessed via your smartphone or our website to contribute in reducing the usage of manuals in paper format, as part of efforts to save the Earth.

Indoor Unit Overview

The appearance of the actual product may differ slightly from the image below.

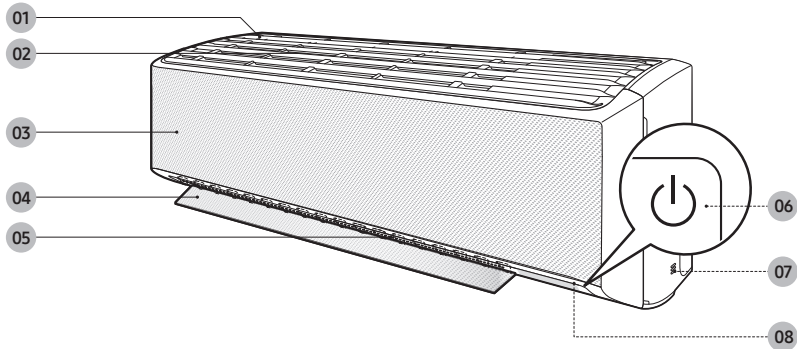

- 01 Air intake
- 02 Air filter
- 03 WindFree panel
- 04 Airflow blade (up and down)
- 05 Airflow blade (left and right)
- 06 Power button/Remote control receiver
- 07 Room temperature sensor
- 08 Display

Display

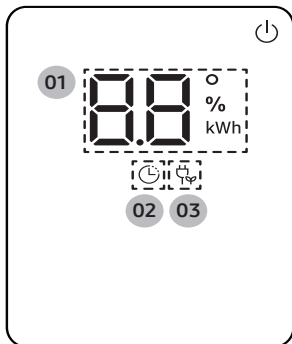

- 01 Temperature indicator (numeric)
Filter reset indicator (CF)
Electricity consumption indicator (numeric)
Auto clean indicator (C i)
- 02 Timer indicator
good'sleep indicator
- 03 Eco indicator

Operating the Air Conditioner

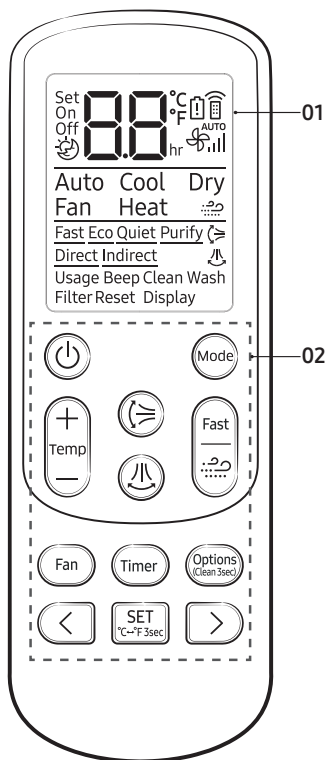

01 Display

02 Button

NOTE

- Although Heat, Purify, Direct and Indirect is displayed on the remote control display, it is not available on this model.
- Features may differ depending on models.

Functions and Buttons

Function	Button and Selection	Display
Power On/Off		
WindFree Cooling	In Cool/Dry/Fan mode ▶	
Auto	▶ ▶ Select Auto.	Auto
Cool	▶ ▶ Select Cool.	Cool
Dry	▶ ▶ Select Dry.	Dry
Fan	▶ ▶ Select Fan.	Fan
Fast	In Cool mode ▶	Fast
Eco	In Cool mode ▶ ▶ ▶ Select Eco. ▶	Eco
Quiet	In Cool mode ▶ ▶ ▶ Select Quiet. ▶	Quiet
Electricity consumption check	In operation ▶ ▶ ▶ Select Usage. ▶	Usage
Beep	▶ ▶ Select Beep. ▶ 	Beep
Freeze Wash	In operation stop condition, ▶ ▶ Select Wash. ▶ 	Wash
Display lighting	▶ ▶ Select Display. ▶ 	Display

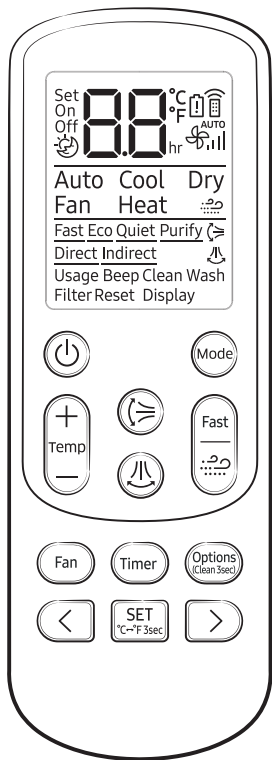

Function	Button and Selection	Display
Timed on/off	<p>Timer ► Select On or Off ►</p> <p>< > (Set the duration.) ►</p> <p>SET °C→°F 3sec</p>	On Off 00 hr
good'sleep	<p>In Cool mode ► Timer (Select ◻) ►</p> <p>< > (Set the duration.) ►</p> <p>SET °C→°F 3sec</p>	80 hr

Cleaning

Auto clean function

Use the Auto clean function if the indoor unit produces odors.

Activating Auto clean

To activate Auto clean, press the  (Options) button for at least 3 seconds.

The indoor unit display shows:

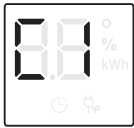

Canceling Auto clean

To cancel Auto clean while it is running, follow the procedure below:



▶ Press and hold for 3 or more seconds.

OR



▶   ▶ Select Clean. ▶ 

Deactivating Auto clean

To deactivate Auto clean, follow the procedure below while the air conditioner is in operation :



▶ Press and hold for 3 or more seconds.

OR



▶   ▶ Select Clean. ▶ 

Cleaning the filter

Clean the air filter every two weeks or when the **CF** (filter-cleaning reminder) appears on the indoor unit display. The time between cleanings may vary, depending on the usage and environmental conditions.

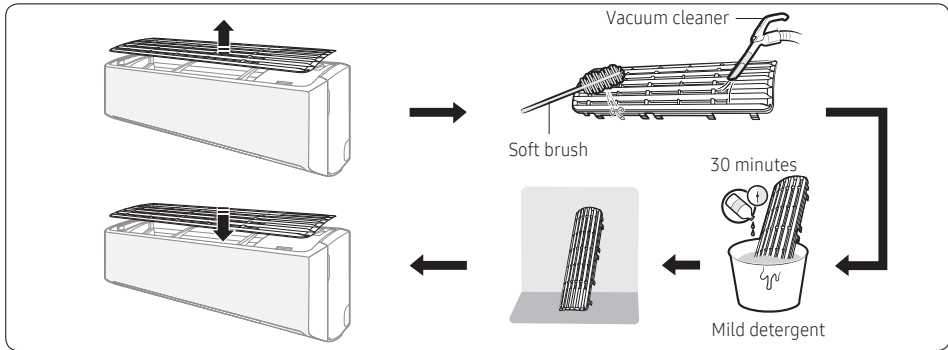

- 1 Slide the filter off of the unit.
- 2 Use a soft brush or vacuum cleaner to remove any dust or debris on the filter.
- 3 Soak the filter in a solution of water and mild detergent for 30 minutes.
- 4 Rinse the filter and let it air dry in a well-ventilated area that is out of direct sunlight.
- 5 Reinstall the filter.
- 6 Reset the filter-cleaning reminder:

In operation ▶  ▶   ▶ Select Filter Reset. ▶ 

SAMSUNG

QUESTIONS OR COMMENTS?

COUNTRY	CALL	OR VISIT US ONLINE AT
PANAMA	800-0101	www.samsung.com/latin/support (Spanish) www.samsung.com/latin_en/support (English)
ECUADOR	1-800-SAMSUN (72-6786)	www.samsung.com/latin/support (Spanish) www.samsung.com/latin_en/support (English)

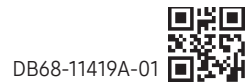

DB68-11419A-01